

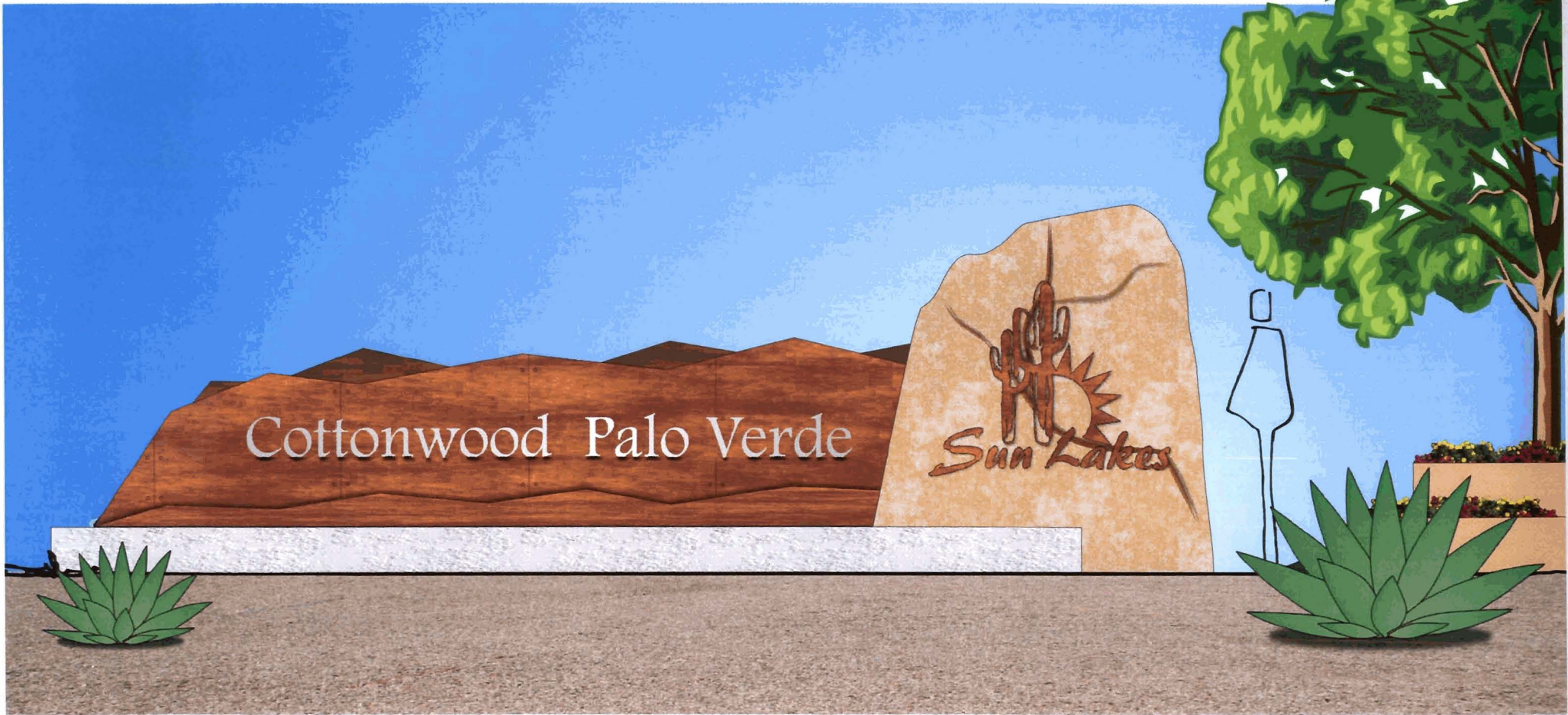

Sun Lakes  
Cottonwood Palo Verde  
Sign Proposal





Graphic Directions, Inc. | 2644 North 24th Avenue Phoenix, Arizona 85009 | p. 602.255.0355 f. 602.256.2435 | www.gdisigns.com

PROJECT <input type="radio"/> Proof Ok As Is <input type="checkbox"/> Proof Ok With Changes <input type="checkbox"/> New Proof Required	CLIENT SIGNATURE OF APPROVAL	DATE
--	------------------------------	------

NOTE: PLEASE READ CAREFULLY AND CHECK THE APPROPRIATE BOX. PRODUCTION SCHEDULES BEGIN UPON APPROVAL OF LAYOUTS.

All Original Layouts Or Designs Whether Preliminary Or Final Are Property Of Graphic Directions, Inc.

JOB NUMBER	DRAWN BY	SCALE	FILE NAME	<input type="checkbox"/> Corrections Needed <input type="checkbox"/> Proof Ready for Productions	DATE	REVISION DATE	IN.
------------	----------	-------	-----------	--	------	---------------	-----

Dan      1" = 4'      JD/Sunlakes/CottonwoodPV      05-12-09      07-22-09

FOR GDI USE ONLY



24

Overhead view

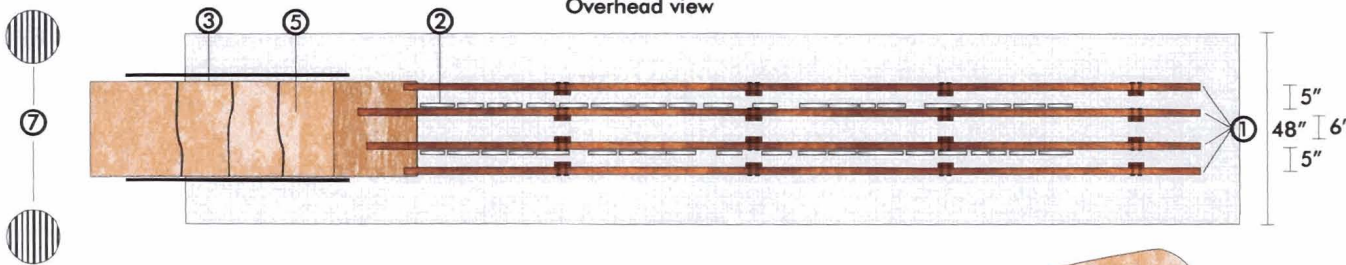

### Flagship Monument

1. FCO 1/8" rusted steel panels
2. FCO 1/2" grained aluminum letters w/clear powder coat.
3. FCO rusted steel logo
4. Cinderblock monument stuccoed with faux sandstone finish
5. Concrete footing
6. LED illuminated track behind steel panel
7. LED spot on logo

Side View looking East

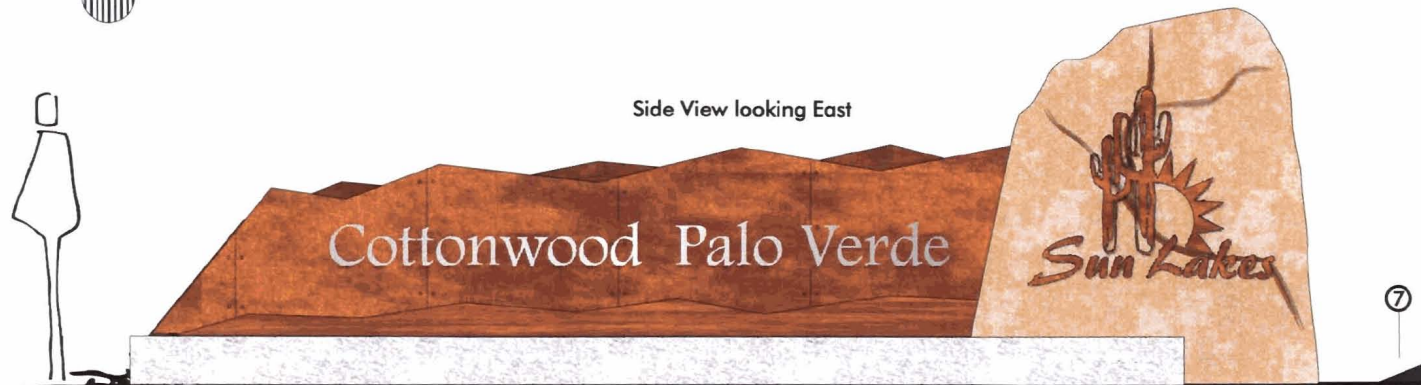

Side View looking West

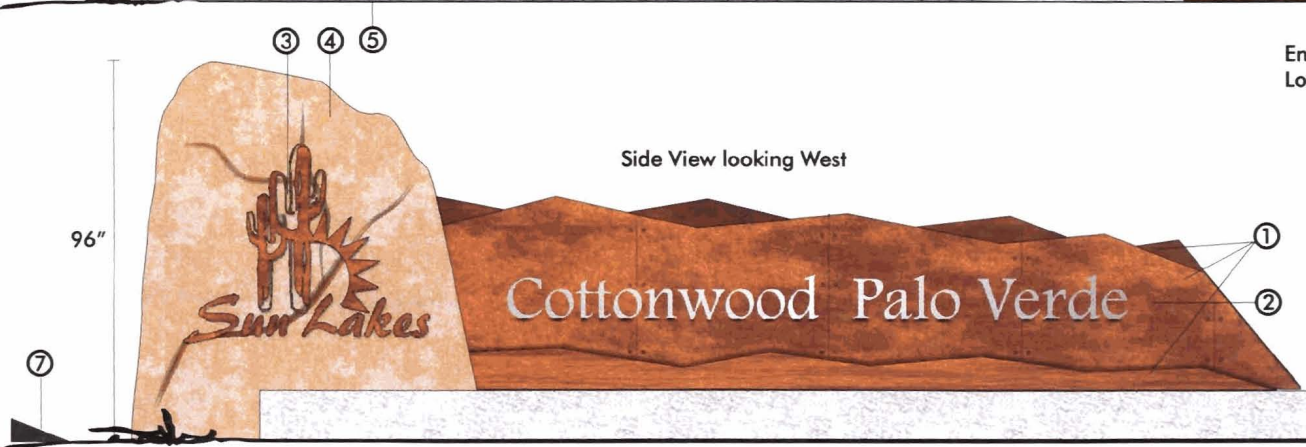

End view Looking North



End view Looking South

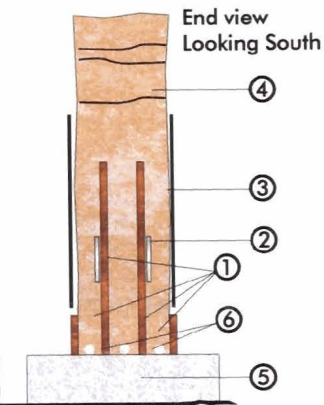

Graphic Directions, Inc. | 2644 North 24th Avenue Phoenix, Arizona 85009 | p. 602.255.0355 f. 602.256.2435 | www.gdisigns.com

○

PROJECT

CLIENT SIGNATURE OF APPROVAL

DATE

Proof Ok As Is  Proof Ok With Changes  New Proof Required

NOTE: PLEASE READ CAREFULLY AND CHECK THE APPROPRIATE BOX. PRODUCTION SCHEDULES BEGIN UPON APPROVAL OF LAYOUTS.

All Original Layouts Or Designs Whether Preliminary Or Final Are Property Of Graphic Directions, Inc.

<b>Dan</b>	<b>1" = 4'</b>	<b>JD/Sunlakes/CottonwoodPV</b>	<input type="checkbox"/> Corrections Needed <input type="checkbox"/> Proof Ready for Productions	<b>05-12-09</b>	<b>07-22-09</b>	
JOB NUMBER	DRAWN BY	SCALE	FILE NAME	DATE	REVISION DATE	IN.

FOR GDI USE ONLY

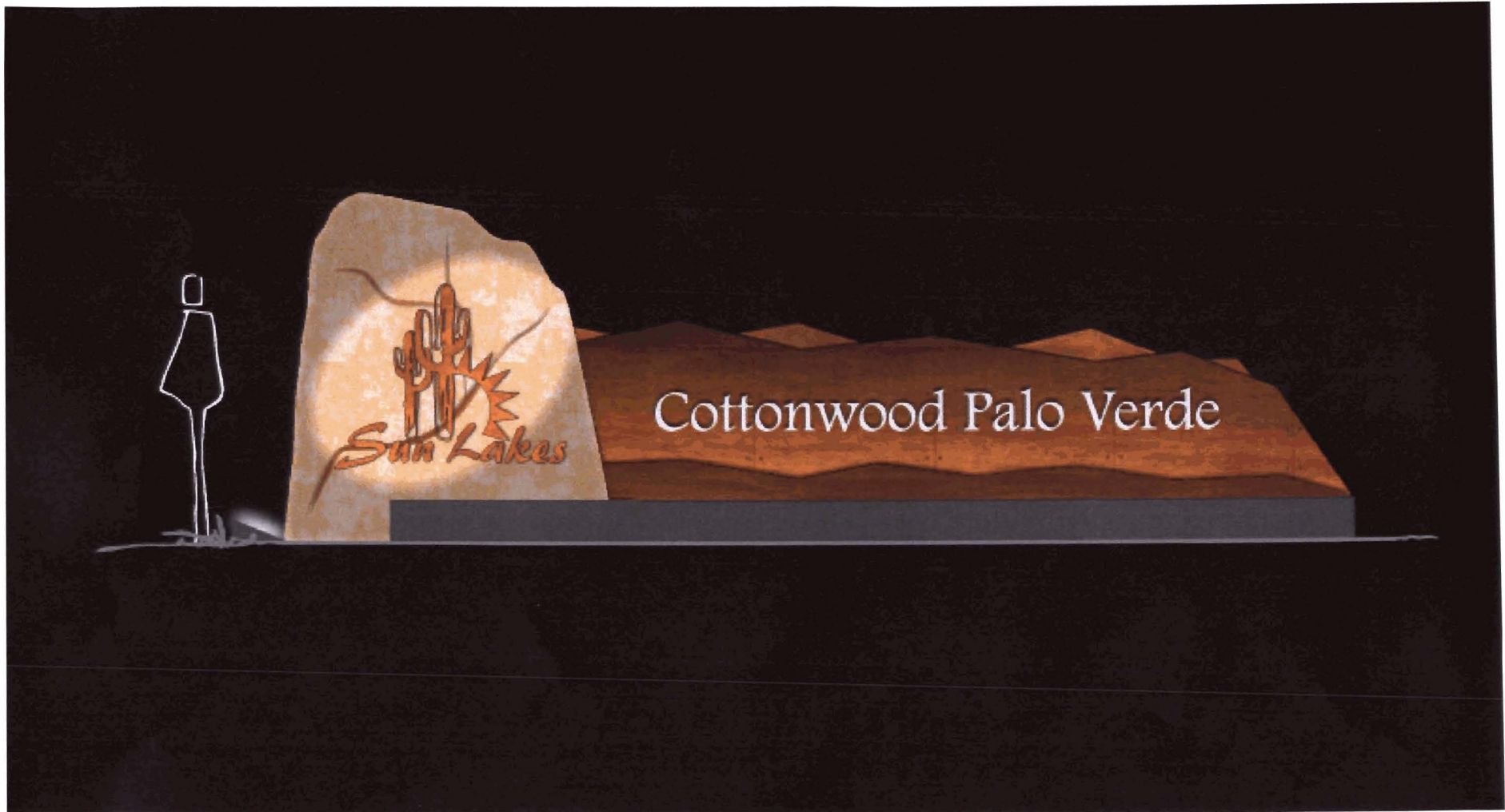

Graphic Directions, Inc. | 2644 North 24th Avenue Phoenix, Arizona 85009 | p. 602.255.0355 f. 602.256.2435 | www.gdisigns.com

O		
---	--	--

PROJECT  Proof Ok As Is  Proof Ok With Changes  New Proof Required CLIENT SIGNATURE OF APPROVAL DATE

NOTE: PLEASE READ CAREFULLY AND CHECK THE APPROPRIATE BOX. PRODUCTION SCHEDULES BEGIN UPON APPROVAL OF LAYOUTS.

All Original Layouts Or Designs Whether Preliminary Or Final Are Property Of Graphic Directions, Inc.

	Dan	None	JD/Sunlakes/CottonwoodPV	<input type="checkbox"/> Corrections Needed	<input type="checkbox"/> Proof Ready for Productions	05-12-09	07-22-09	
JOB NUMBER	DRAWN BY	SCALE	FILE NAME			DATE	REVISION DATE	IN.

FOR GDI USE ONLY



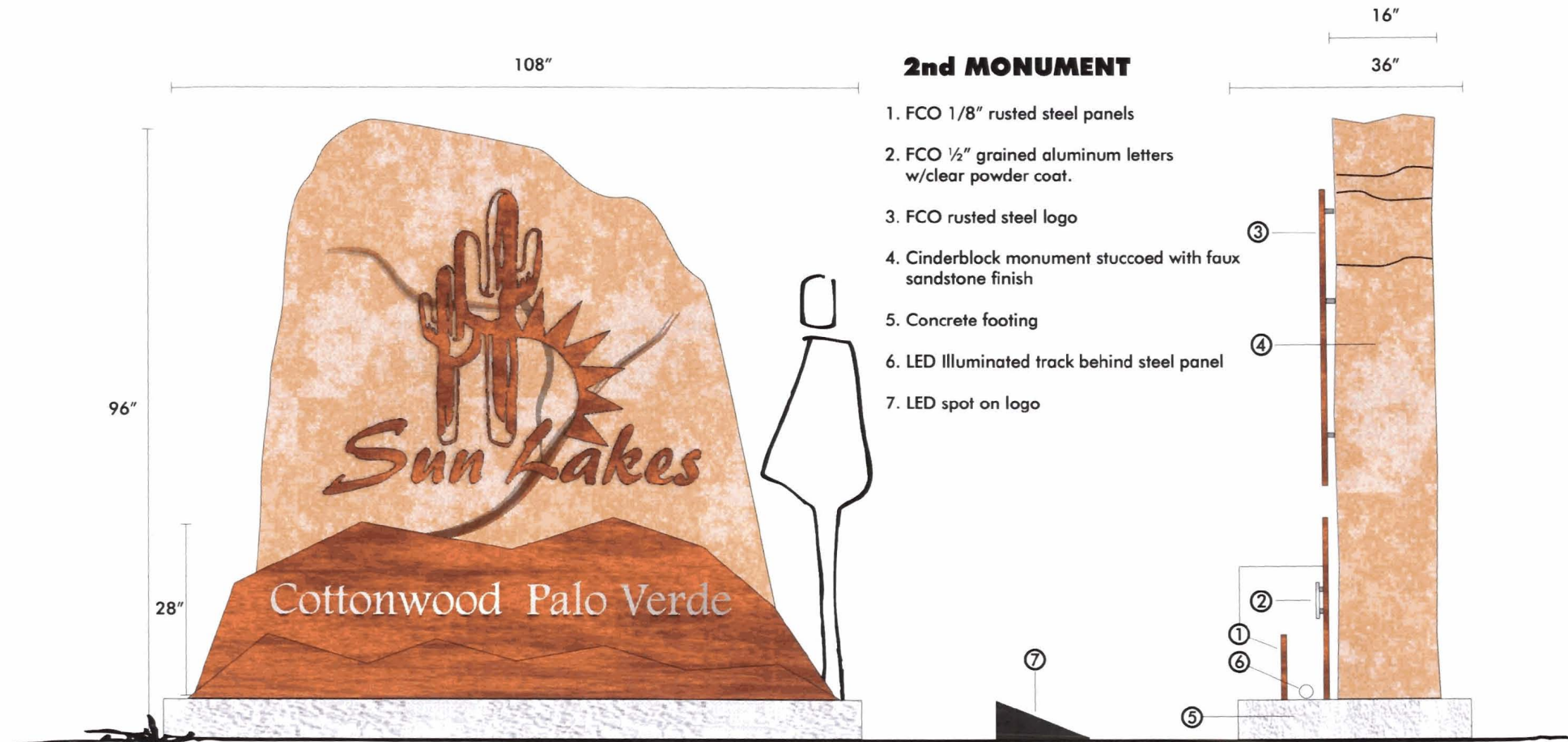

**2nd MONUMENT**

1. FCO 1/8" rusted steel panels
2. FCO 1/2" grained aluminum letters w/clear powder coat.
3. FCO rusted steel logo
4. Cinderblock monument stuccoed with faux sandstone finish
5. Concrete footing
6. LED illuminated track behind steel panel
7. LED spot on logo



Graphic Directions, Inc. | 2644 North 24th Avenue Phoenix, Arizona 85009 | p. 602.255.0355 f. 602.256.2435 | www.gdisigns.com

PROJECT: \_\_\_\_\_ CLIENT SIGNATURE OF APPROVAL: \_\_\_\_\_ DATE: \_\_\_\_\_

Proof Ok As Is  Proof Ok With Changes  New Proof Required

NOTE: PLEASE READ CAREFULLY AND CHECK THE APPROPRIATE BOX. PRODUCTION SCHEDULES BEGIN UPON APPROVAL OF LAYOUTS.

All Original Layouts Or Designs Whether Preliminary Or Final Are Property Of Graphic Directions, Inc.

<b>Dan</b>	<b>1"=2'</b>	<b>JD/Sunlakes/CottonwoodPV</b>	<input type="checkbox"/> Corrections Needed <input type="checkbox"/> Proof Ready for Productions	<b>05-12-09</b>	<b>07-22-09</b>	
JOB NUMBER	DRAWN BY	SCALE	FILE NAME	DATE	REVISION DATE	IN.

FOR GDI USE ONLY

# Kiosk

1. 48 x 86 aluminum cabinet.
2. 1/8" Rusted steel panels
3. 1/8" FCO aluminum letters and logo
4. LED Backlit digital print
5. Concrete footing
6. Faux Sandstone veneer

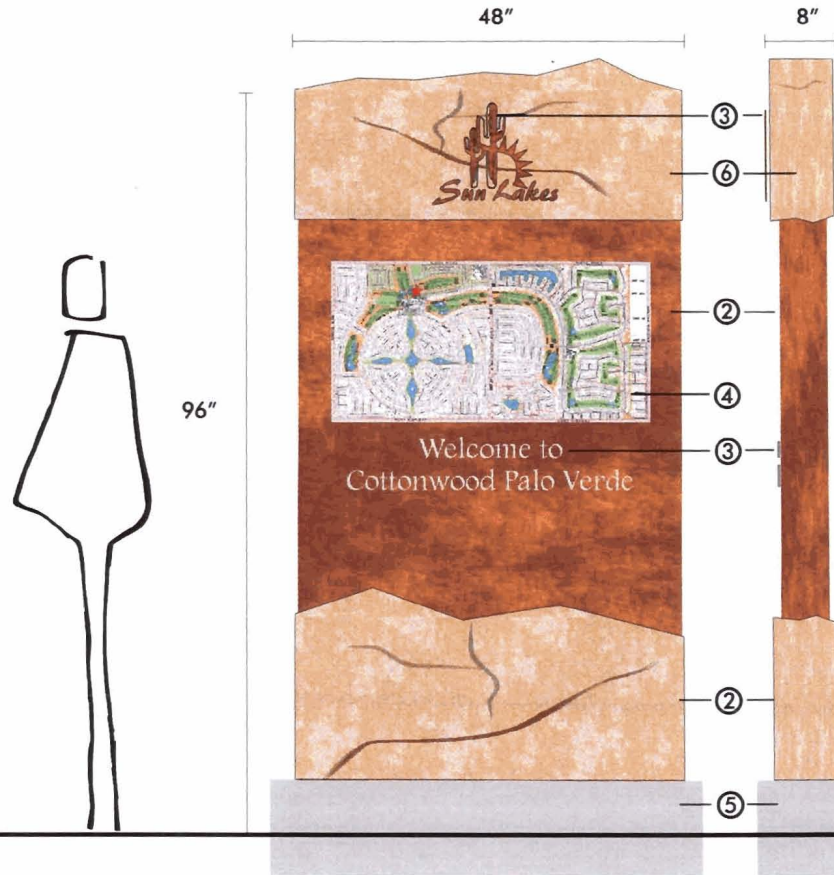

Graphic Directions, Inc. | 2644 North 24th Avenue Phoenix, Arizona 85009 | p. 602.255.0355 f. 602.256.2435 | www.gdisigns.com

O

PROJECT

CLIENT SIGNATURE OF APPROVAL

DATE

Proof Ok As Is  Proof Ok With Changes  New Proof Required

NOTE: PLEASE READ CAREFULLY AND CHECK THE APPROPRIATE BOX. PRODUCTION SCHEDULES BEGIN UPON APPROVAL OF LAYOUTS.

All Original Layouts Or Designs Whether Preliminary Or Final Are Property Of Graphic Directions, Inc.

	Dan	1"=2'	JD/Sunlakes/CottonwoodPV	<input type="checkbox"/> Corrections Needed <input type="checkbox"/> Proof Ready for Productions	05-12-09	07-22-09	
JOB NUMBER	DRAWN BY	SCALE	FILE NAME		DATE	REVISION DATE	IN.

FOR GDI USE ONLY

# Directionals

1. 1/4" Rusted Steel Panel w/reverse cutout logo and text
3. Reflective Vinyl show-through backer
4. Concrete footing
5. Faux Sandstone veneer
7. 1/4" Rusted Steel Panel

All Front-lit w/LED spot



Graphic Directions, Inc. | 2644 North 24th Avenue Phoenix, Arizona 85009 | p. 602.255.0355 f. 602.256.2435 | www.gdisigns.com

PROJECT

CLIENT SIGNATURE OF APPROVAL

DATE

Proof Ok As Is  Proof Ok With Changes  New Proof Required

NOTE: PLEASE READ CAREFULLY AND CHECK THE APPROPRIATE BOX. PRODUCTION SCHEDULES BEGIN UPON APPROVAL OF LAYOUTS.

All Original Layouts Or Designs Whether Preliminary Or Final Are Property Of Graphic Directions, Inc.

JOB NUMBER	DRAWN BY	SCALE	FILE NAME	<input type="checkbox"/> Corrections Needed <input type="checkbox"/> Proof Ready for Productions	DATE	REVISION DATE	IN.
	Dan	1"=4'	JD/Sunlakes/CottonwoodPV		05-12-09	07-22-09	

FOR GDI USE ONLY



**Composite logo**

1/8" Rusted Steel Panel w/reverse cutout logo and text



Graphic Directions, Inc. | 2644 North 24th Avenue Phoenix, Arizona 85009 | p. 602.255.0355 f. 602.256.2435 | www.gdisigns.com

○ \_\_\_\_\_

PROJECT CLIENT SIGNATURE OF APPROVAL DATE

Proof Ok As Is  Proof Ok With Changes  New Proof Required NOTE: PLEASE READ CAREFULLY AND CHECK THE APPROPRIATE BOX. PRODUCTION SCHEDULES BEGIN UPON APPROVAL OF LAYOUTS.

All Original Layouts Or Designs Whether Preliminary Or Final Are Property Of Graphic Directions, Inc.

	Dan	1"=4'	JD/Sunlakes/CottonwoodPV	<input type="checkbox"/> Corrections Needed <input type="checkbox"/> Proof Ready for Productions	05-12-09	07-22-09	
JOB NUMBER	DRAWN BY	SCALE	FILE NAME		DATE	REVISION DATE	IN.



## LED Light Info

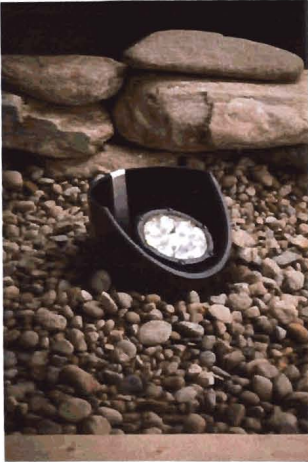

**Spot Light**  
Kichel LED warm white spot  
15 year replacement warranty

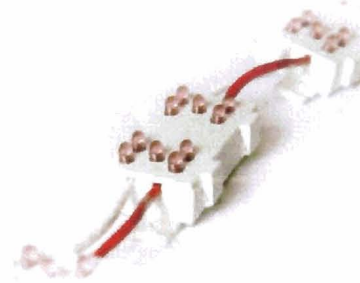

**LED Module lighting**  
CAO Luxembright warm LED  
4 year replacement warranty

## Solar Component Info

### SunLight

Solar lighting controller  
10A or 20A  
12 VDC or 24 VDC  
10 different lighting options



SunLight solar controller  
5 year replacement warranty

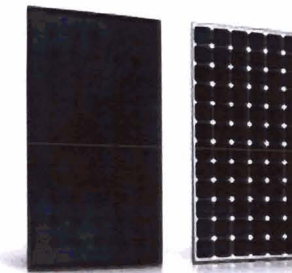

Solar Panel  
20-25 year replacement warranty

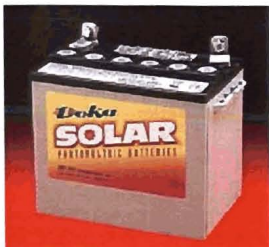

Battery  
1 year replacement warranty  
2 year average lifespan

